

**Elemental**  
 1606 8th Ave. N  
 Seattle, WA 98109  
 P 206.285.1464  
 F 206.285.1444

© PB Elemental Architecture, LLC 2006  
 This drawing is the property of PB Elemental Architecture, LLC. It is to be used only for the project and location specified herein. No part of this drawing may be reproduced or transmitted in any form or by any means, electronic or mechanical, including photocopying, recording, or by any information storage and retrieval system, without the prior written permission of PB Elemental Architecture, LLC. These rights shall not be limited by any applicable laws. They are not intended for use on any other project.  
 Shaded drawing scale is based on 3/4" x 3/4" sheet.

House 35th St.

3500 Troll Ave N,  
 WA 98103

No.	Date	Issue
07	21.06	Schematic
10	27.06	Permit Set
01	23.07	Corrections
01	14.08	Construction

Building One  
 Floorplans

Pb Job #: 149

# A2.0

Sheet

BLDG A AREA SUMMARY	
<b>UNITS 1</b>	
FIRST FLOOR	478 SF
SECOND FLOOR	520 SF
THIRD FLOOR	520 SF
<b>TOTAL</b>	<b>1518 SF</b>
	44 SF OPEN DECK

BLDG A AREA SUMMARY	
<b>UNIT 2</b>	
FIRST FLOOR	510 SF
SECOND FLOOR	520 SF
THIRD FLOOR	520 SF
<b>TOTAL</b>	<b>1550 SF</b>
	42 SF OPEN DECK

BLDG A AREA SUMMARY	
<b>UNIT 3</b>	
FIRST FLOOR	473 SF
SECOND FLOOR	487 SF
THIRD FLOOR	497 SF
<b>TOTAL</b>	<b>1457 SF</b>
	48 SF OPEN DECK

BLDG B AREA SUMMARY	
<b>UNIT 4</b>	
FIRST FLOOR	462 SF
SECOND FLOOR	477 SF
THIRD FLOOR	462 SF
<b>TOTAL</b>	<b>1401 SF</b>
	325 SF ROOF DECK

BLDG C AREA SUMMARY	
<b>UNIT 5</b>	
FIRST FLOOR	398 SF
SECOND FLOOR	413 SF
THIRD FLOOR	413 SF
<b>TOTAL</b>	<b>1224 SF</b>
	326 SF ROOF DECK

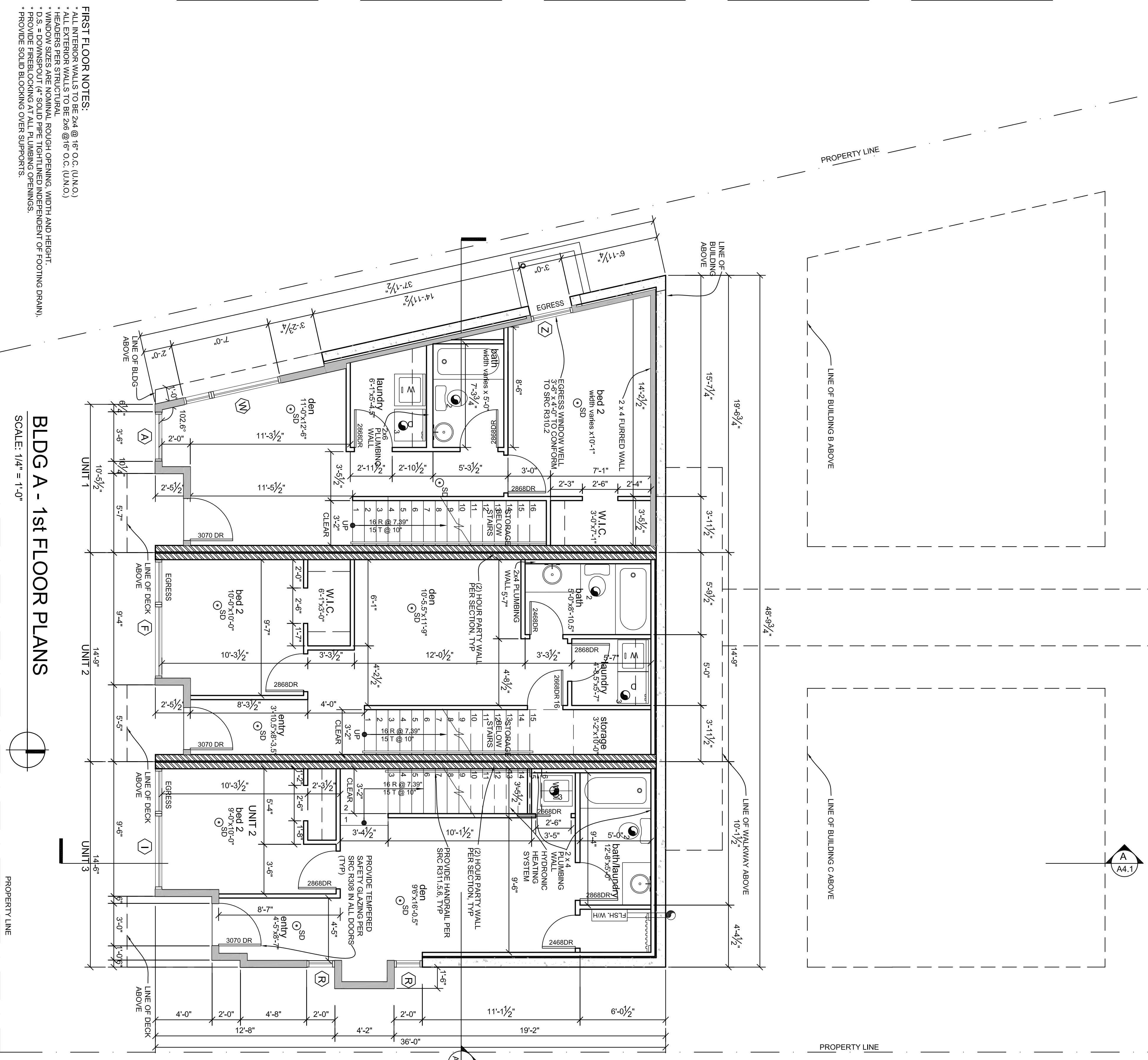

## BLDG A - 1st FLOOR PLANS

SCALE: 1/4" = 1'-0"

- FIRST FLOOR NOTES:**
- \* ALL INTERIOR WALLS TO BE 2x4 @ 16 O.C. (U.N.O.)
  - \* ALL EXTERIOR WALLS TO BE 2x6 @ 16 O.C. (U.N.O.)
  - \* ALL EXTERIOR WALLS TO BE 2x6 @ 16 O.C. (U.N.O.)
  - \* WINDOW SIZES ARE NOMINAL. ROUGH OPENING WIDTH AND HEIGHT.
  - \* D.S. = DOWNSPOUT. 4" SOLID PIPE TIGHTENED INDEPENDENT OF FOOTING DRAIN.
  - \* PROVIDE FIREBLOCKING AT ALL PLUMBING OPENINGS.
  - \* PROVIDE SOLID BLOCKING OVER SUPPORTS.